

Detailed Product Description:
Waterproof connector rating is IP69K
They can not be used permanently under water
Per ISO-20653,IEC60529

Core wire: 24~18AWG
Cable peeling: 25mm
Core wire peeling: 3~4mm

Other Specification
Contact Pin: Brass with gold-plated
Insulation plastic: PA66
Shell: Zinc alloy
Mechanical characteristics: mating / cycle >100cycle
Operating temperature: -40°C ~ +85°C

ALL MATERIALS ARE RoHS COMPLIANT

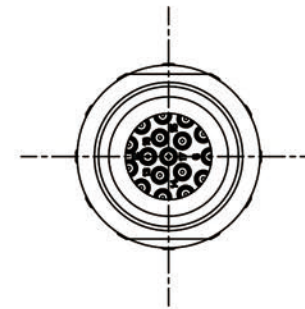
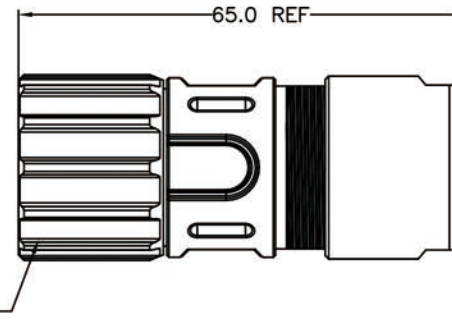
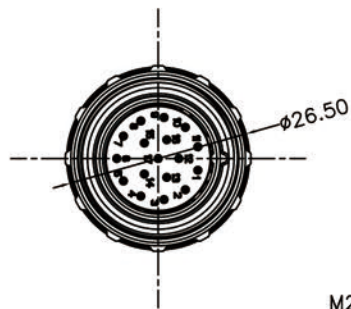

Electrical character

Part Number	Contacts	Rated voltage		Rated current	Contact Resistance	Cable OD (mm)
		A/C	D/C			
230012-01-012		150V	150V	8A	5mΩ	7~12
230017-01-006		150V	150V	8A	5mΩ	7~12
230019-01-008		150V	150V	16*8A+3*10A	5mΩ	7~12

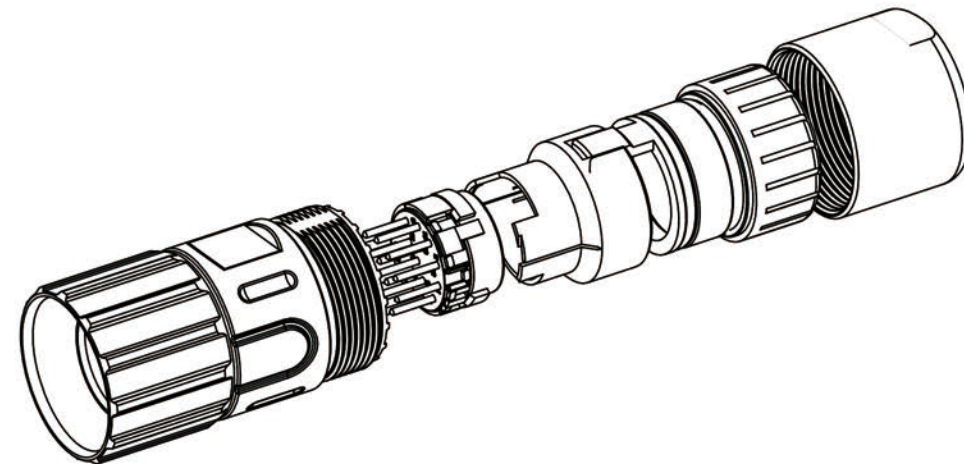

SIGNAL® Shenzhen Signal Electronics Co., LTD		TITLE M23 MALE METAL ASSEMBLY CONNECTOR	
		SGN NO SEE TABLE	REV. SO
DRAWN BY	DATE	DWG NO	CUSTOMER
CHECKED BY	DATE		
CHECKED BY	DATE		
APPROVED BY	DATE	TOLERANCES ARE:	
<small>THE INFORMATION CONTAINED IN THIS DRAWING IS THE SOLE PROPERTY OF SIGNAL COMPANY. ANY REPRODUCTION IN PART OR WHOLE WITHOUT THE WRITTEN PERMISSION OF SIGNAL COMPANY IS PROHIBITED.</small>		DECIMALES	ANGLES
		.x ±0.5	x.* ±2.0°
		.xx ±0.20	.x* ±1.0°
		THIRD ANGLE PROJECTION	
		SIZE: A4	UNITS: mm
		SCALE:	SHEET: 1 OF 1